



Marist Canberra Football Club



CAPITAL
FOOTBALL

COVID PLAN **ALL AGE GROUPS**

VERSION 1 – 9 JULY 2020

Club Submission

This COVID Play plan is provided by Marist Canberra Football Club

This plan outlines our operational delivery of matches in the following leagues

- ▶ MiniRoos Age 10 & 11, and
- ▶ Junior League Age 12 to 18.

This plan will be in place for the duration of the 2021 football season

The club contact responsible for this plan is;

Troy Kleppe

President@maristfootball.com.au

0404704318

The Club acknowledges that this plan is in accordance with the Capital Football and Marist College Canberra COVID-19 Guidelines.

General Precautions

Observe 1.5m Rule

Attendance

Participants (including players, parents, coaches, referees, volunteers) are not to return to matches if they:

- ▶ Feel unwell;
- ▶ Have any flu-like symptoms;
- ▶ Have travelled internationally or been exposed to a person with COVID-19 in the preceding 14 days; or
- ▶ Are at a high risk from a health perspective, including the elderly and those with pre-existing medical health conditions
- ▶ Attendees are encouraged to register with check in CBR at all venues they attend.

Hygiene

- ▶ Spaces, surfaces and objects at each venue will be subject to periodic cleaning
- ▶ Sanitiser will be available at a number of points around the grounds including admin trolley, canteen, technical areas. Club and team officials are encouraged to sanitise regularly.
- ▶ Coaches to ensure players sanitise as appropriate.
- ▶ No sharing of drink bottles
- ▶ Bins are provided around the venue - encourage use

Behaviour

- ▶ Cover mouth and nose with a tissue or your elbow (not your hands) when you cough or sneeze;
- ▶ If using tissues, place them directly in the bins provided;
- ▶ No spitting at any time



What is permitted during Match Play

The following is permitted at the venue and during match play;

- ▶ Full competitive and non-competitive matches are permitted within the normal Laws of the Game
- ▶ Where possible, players should come ready to play
- ▶ Play only – get in, play, get out
- ▶ Social activities when games have concluded are discouraged players and coaching staff need to exit the playing area as soon as possible after the game – so we can clean benches etc.
- ▶ Spectator should exit the area as soon as possible after the game, noting any requirements for Marist Parents to pack up fields.
- ▶ Multiple spectators are not encouraged, (1 per player is preferred, no more than 2)
- ▶ Physical distancing of 1.5 metres between spectators – Club Vested Official will assist
- ▶ Although available, the use of changerooms as a group is discouraged at Marist grounds – please turn up ready to play.
- ▶ The Marist Canteens and BBQ's will function in accordance with ACT Government guidelines.



What is NOT permitted during Match Play

The following is NOT permitted at the venue and during match play;

- ▶ Handshakes before and after the match
- ▶ Team huddles and high fives
- ▶ Multiplayer goal celebrations
- ▶ Spitting
- ▶ Sharing of equipment including drink bottles, towels, shin pads and bibs
- ▶ Post match group photos



Match Operations at Venue

Entry and Exits – common sense applies

- Marist will use a number of grounds with varying pathing requirements. Pathing maps are provided for each ground at the end of this plan.
- In the event you are at the Phillip ground please liaise with other field users (if any) and use the pathing as necessary.
- Club Vested Officials are to remind and assist spectators of the pathing arrangements and social distancing obligations.

Spectators / Pathing

- Players are encouraged to limit spectator numbers
- Spectators to follow pathing as much as possible, particularly if and when there are crowds
- Spectator pathing is in the main around the outside of the fields.
- Player pathing is between fields.
- Focus on maintaining 1.5m distances wherever possible ie spectating or using amenities and moving around the grounds.
- Check in CBR QR codes are posted around the Marist hosted venues



Match Operations at Venue

Canteens

- Max 5 people permitted in canteen
- No children permitted in canteen
- No person displaying illness to be in canteen
- Staff to sanitise before entering canteen and frequently while in service
- All staff to wear gloves
- Staff handling money **not** to handle food
- Serving spaces to be wiped clean frequently
- Sanitiser to be available on counter
- Remind patrons of social distancing when queuing

Amenities

- Bathrooms are to be accessed following pathing protocols – most are accessed on the exit path behind the pavilion building. Return to the playing area can occur by re-joining the entry traffic
- Soap hand towel and sanitiser is available at all amenities and around the grounds.
- Change rooms are available although use for other than ablutions is discouraged, **arrive ready to play**
- Amenities will be clean at the start of matches.
- Room capacity signs will be posted on entry points
- Soap / hand towel / sanitiser should be available at all amenities.



Venue Map Marist College

Marist College Map



MaristCollege
Canberra

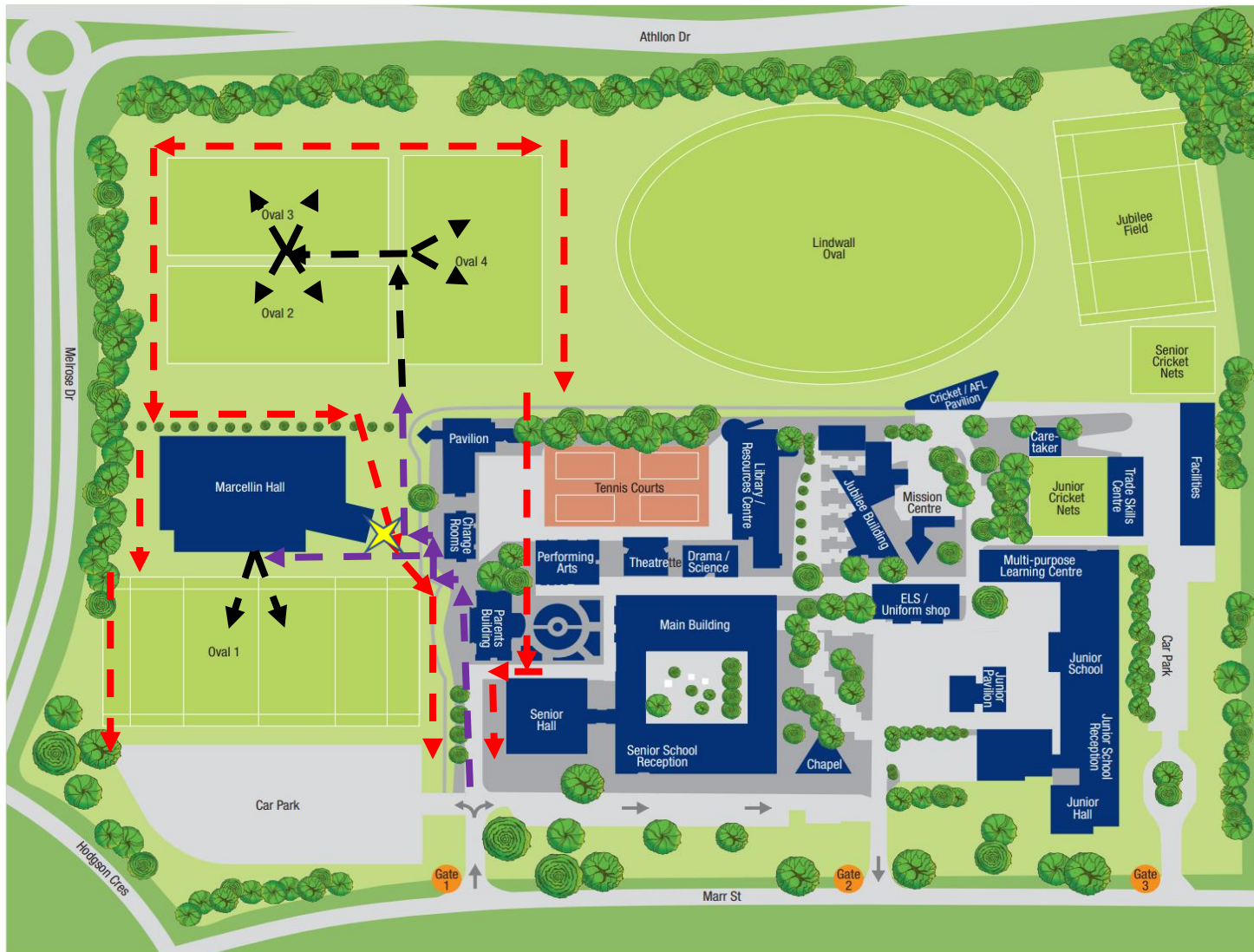

Legend – Football/Rugby

Entry



Field entry



Exit



Trace station



Football/Rugby Game Day

Enter via Gate 1 and Exit venue via Gate 1-2.

Parking in front Senior School and above Oval 1.



CAPITAL
FOOTBALL

Marist College Football Fields

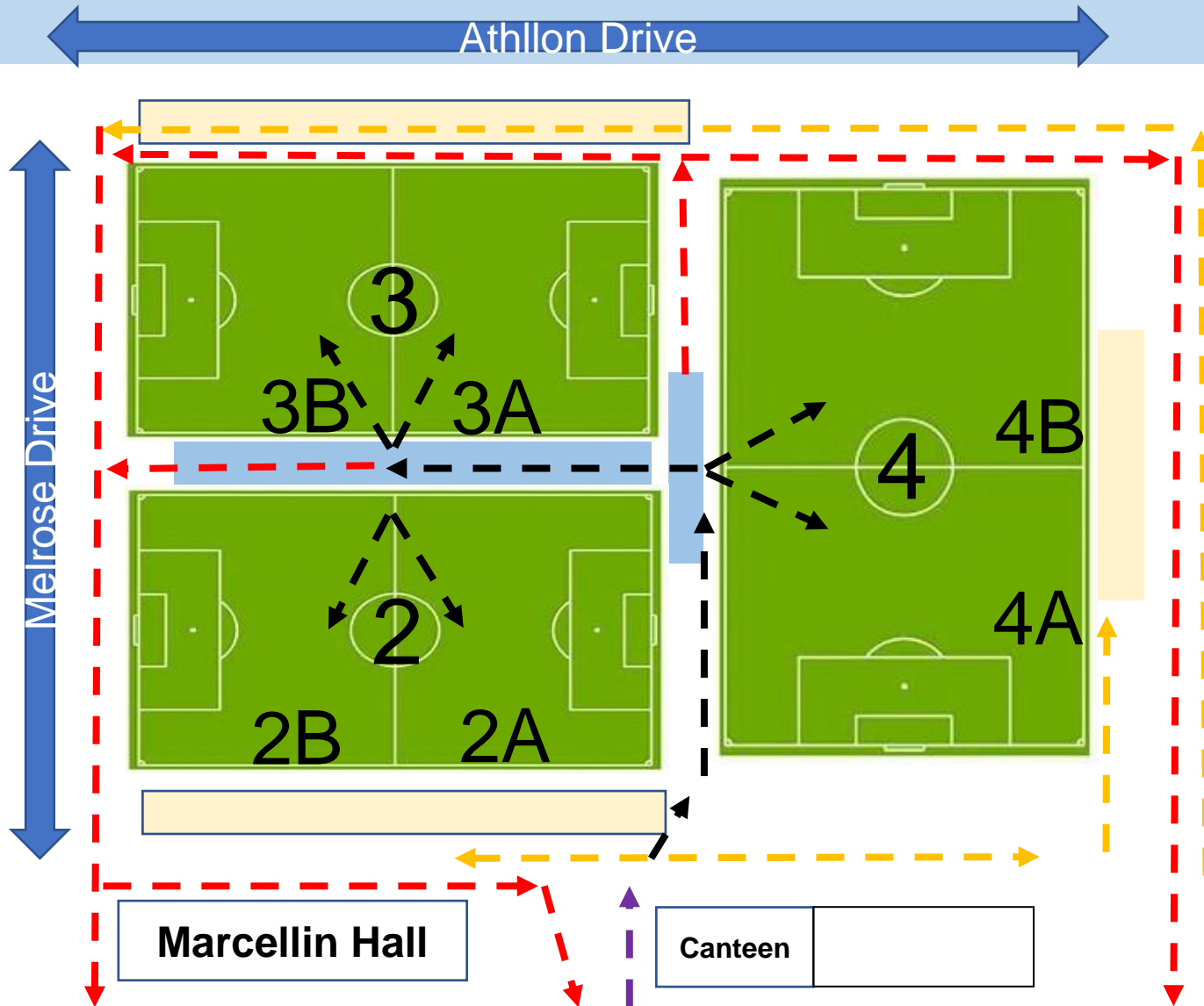

Legend

- Venue entry
- Field entry
- Spectator entry
- Field exit
- Spectator zone
- Technical zone
- Field number **2**

Marist College
Canberra



(44)937779923733

Can't scan? Enter the code **923733** manually to check in.

Phillip Football Fields

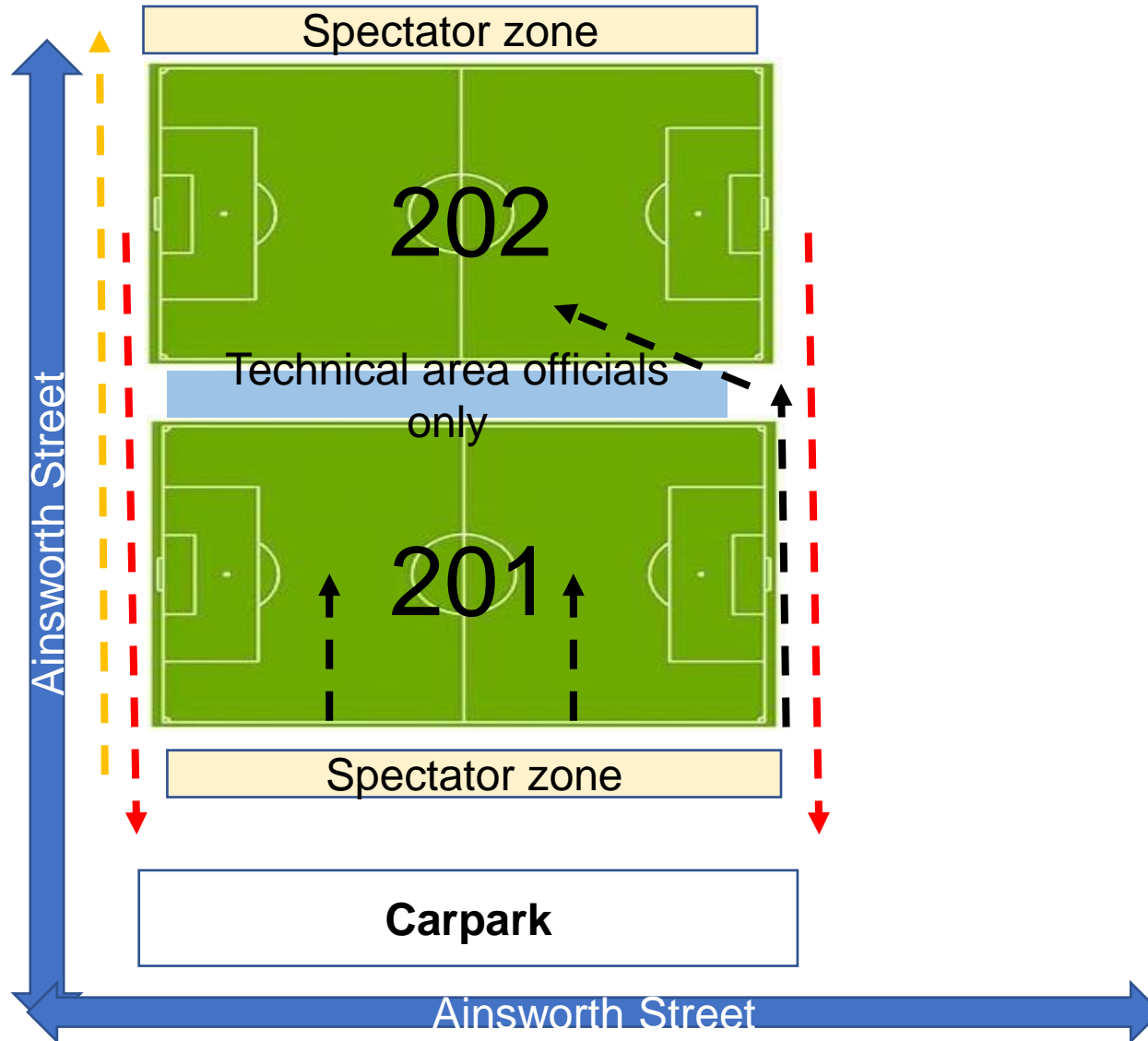

Legend

- Venue entry
- Field entry
- Spectator entry
- Field exit
- Spectator zone
- Technical zone
- Field number **2**

Marist College Canberra - Phillip

Oval



Can't scan? Enter the code **800096** manually to check in.

School Ovals

-

Phillip Oval

STAY SAFE WITH THE CHECK IN CBR APP



Download the APP from



Open the app and scan the QR Code
to register your visit

Marist College
Canberra



(6449)37779923733

Can't scan? Enter the code **923733** manually to check in.

Thank you for supporting COVID-19 contact tracing efforts
and doing your bit to keep Canberrans safe.

Questions? Call the **COVID-19 helpline (02) 6207 7244**
from 8am-8pm daily



For further information visit
covid19.act.gov.au/check-in-cbr



STAY SAFE WITH THE CHECK IN CBR APP



Download the APP from



Open the app and scan the QR Code
to register your visit

Marist College Canberra
Marist College Canberra - Phillip
Oval



(6449)3177980096

Can't scan? Enter the code **800096** manually to check in.

Thank you for supporting COVID-19 contact tracing efforts
and doing your bit to keep Canberrans safe.

Questions? Call the **COVID-19 helpline (02) 6207 7244**
from 8am-8pm daily



For further information visit
covid19.act.gov.au/check-in-cbr



Pearce Oval

-

Curtin Oval

STAY SAFE WITH THE CHECK IN CBR APP



Download the APP from



Open the app and scan the QR Code
to register your visit

Marist College Canberra

Marist College Canberra - Pearce Oval



(454)9177779800072

Can't scan? Enter the code **800072** manually to check in.

Thank you for supporting COVID-19 contact tracing efforts
and doing your bit to keep Canberrans safe.

Questions? Call the **COVID-19 helpline (02) 6207 7244**
from 8am-8pm daily



For further information visit
covid19.act.gov.au/check-in-cbr



STAY SAFE WITH THE CHECK IN CBR APP



Download the APP from



Open the app and scan the QR Code
to register your visit

Marist College Canberra

Marist College Canberra - Curtin Oval



(454)9377779800002

Can't scan? Enter the code **800102** manually to check in.

Thank you for supporting COVID-19 contact tracing efforts
and doing your bit to keep Canberrans safe.

Questions? Call the **COVID-19 helpline (02) 6207 7244**
from 8am-8pm daily



For further information visit
covid19.act.gov.au/check-in-cbr

